

# SAFETY INSTRUCTIONS

## RAPID RESPONSE™ PIPE REPAIR SYSTEM

**WARNINGS:** This product does not retain axial pipe movement. This product does not repair a full circumferential pipe leak.

### IMPORTANT SAFETY POINTS

- 1** Wear safety glasses during installation.
- 2** When using the Adjusting Nut, don't over-tighten the tension chain while adjusting clamp to suit pipe diameter.
- 3** Don't use levers (excessive force) on the handle to lock the clamp.
- 4** Make sure the chains don't get twisted during installation
- 5** Keep hands and fingers clear of pinch points on clamp while locking the handle.
- 6** Ensure the tension chain is on the chain hook correctly before locking handle.
- 7** Use caution when installing the clamp to avoid any damage to the membrane seal.
- 8** If using a copper sheet and clamps combined, use protective gloves to avoid injury.

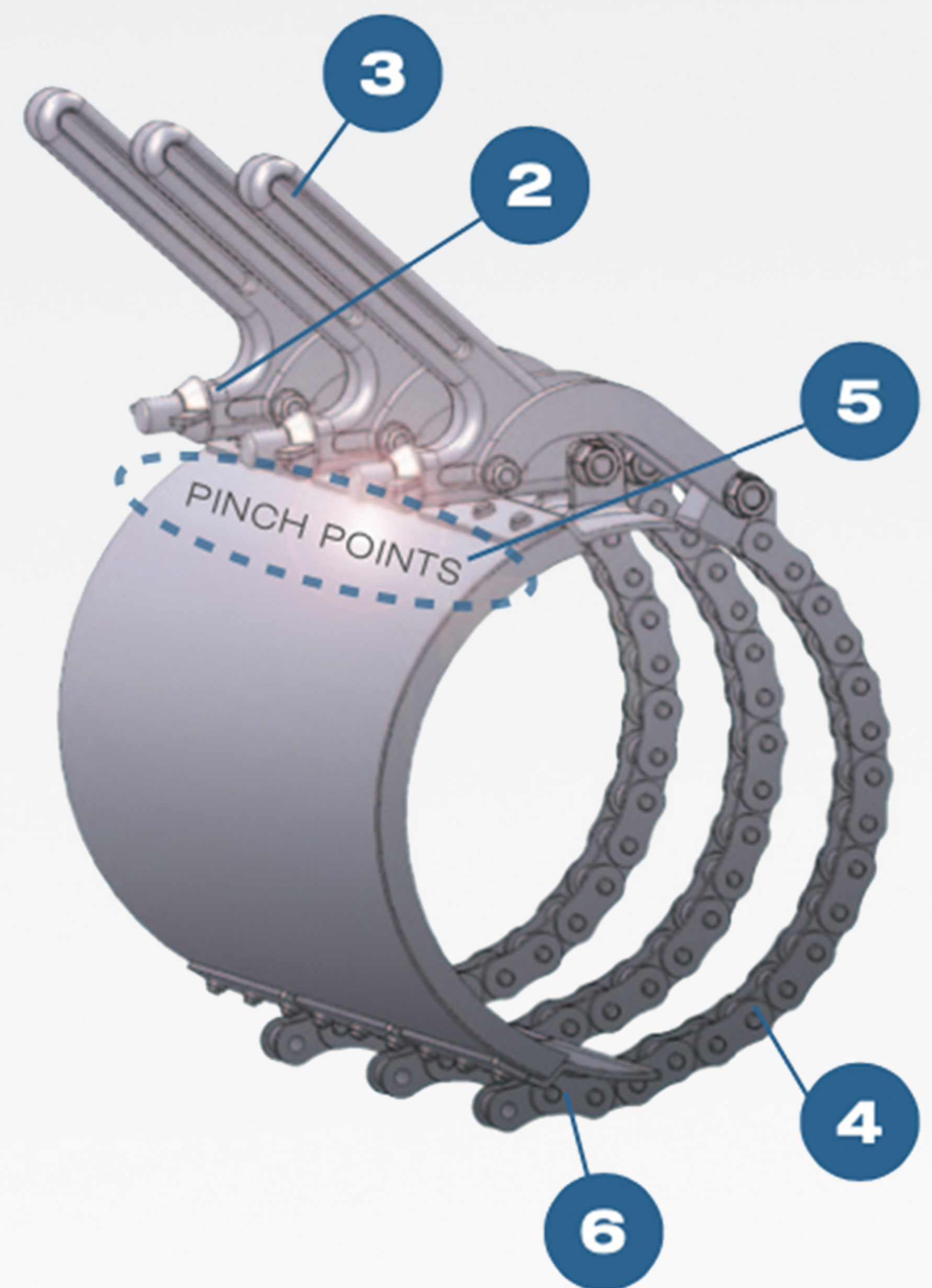



# INSTALLATION INSTRUCTIONS

## RAPID RESPONSE™ PIPE REPAIR SYSTEM

BEFORE COMMENCING, PLEASE READ  
THE REVERSE SIDE OF THIS SHEET  
(SAFETY INSTRUCTIONS)

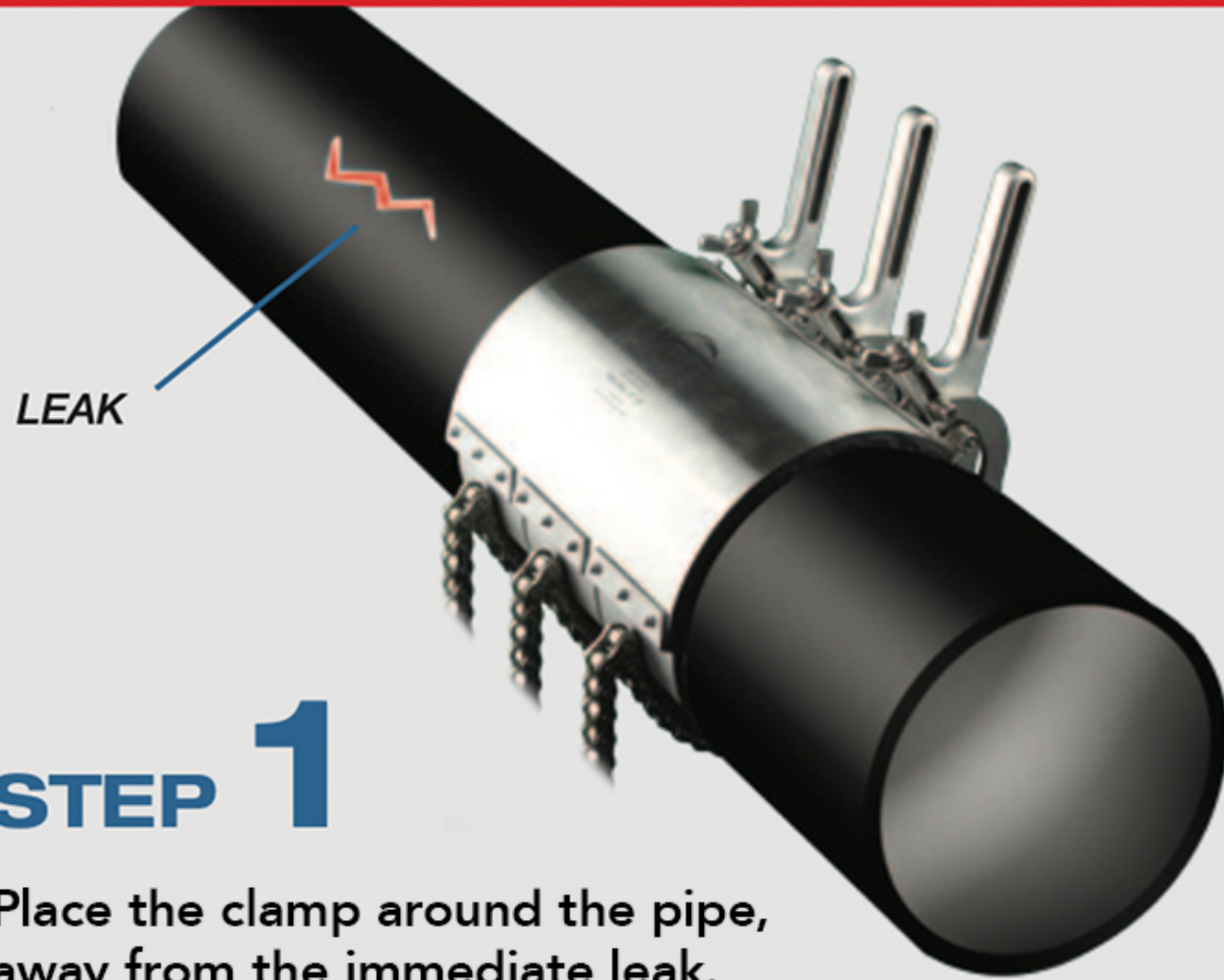

### STEP 1

Place the clamp around the pipe,  
away from the immediate leak.  
Pre-tension the chain and locking  
handle to suit the pipe diameter.



### STEP 2

Release the handle tension.

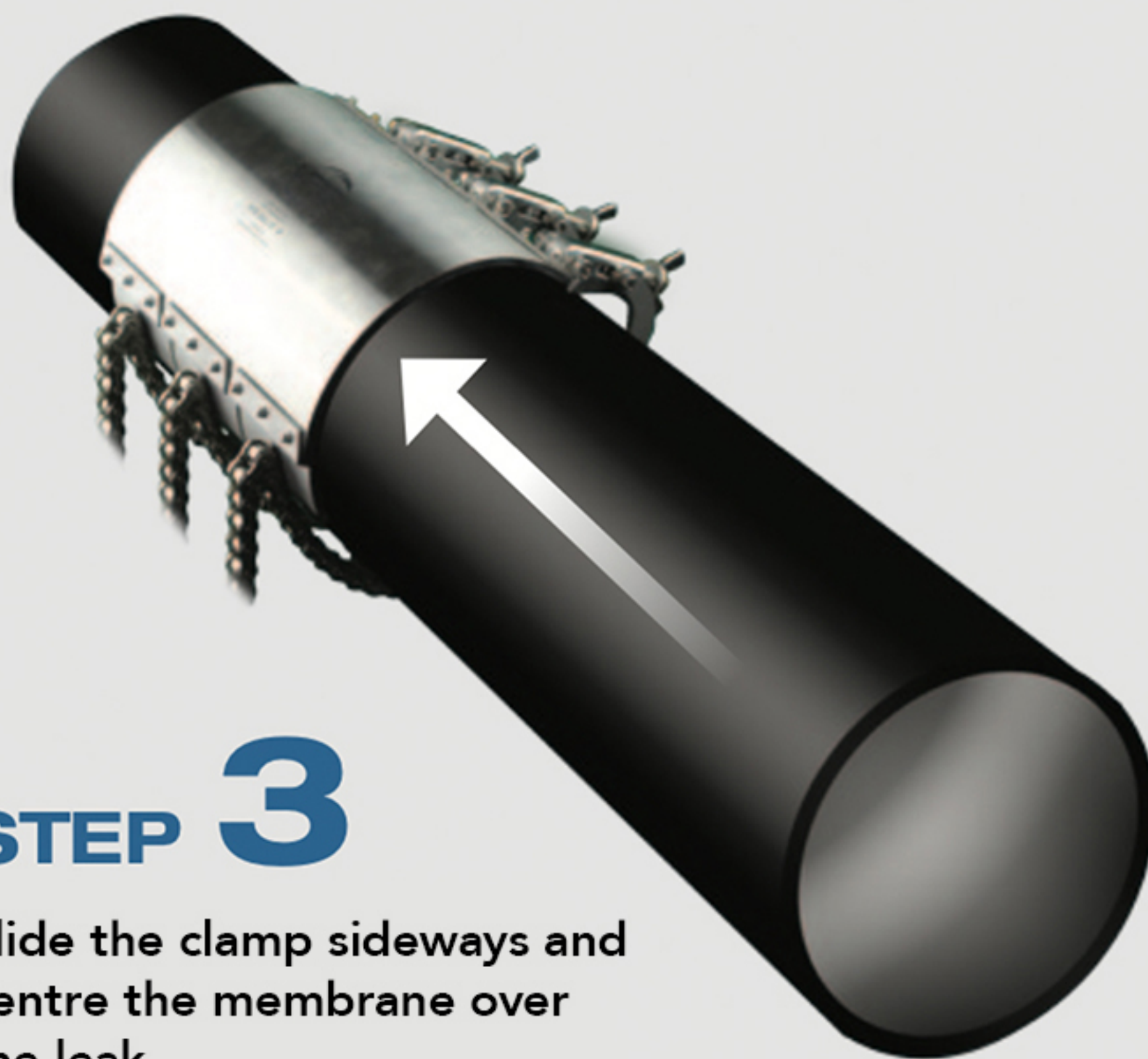

### STEP 3

Slide the clamp sideways and  
centre the membrane over  
the leak.

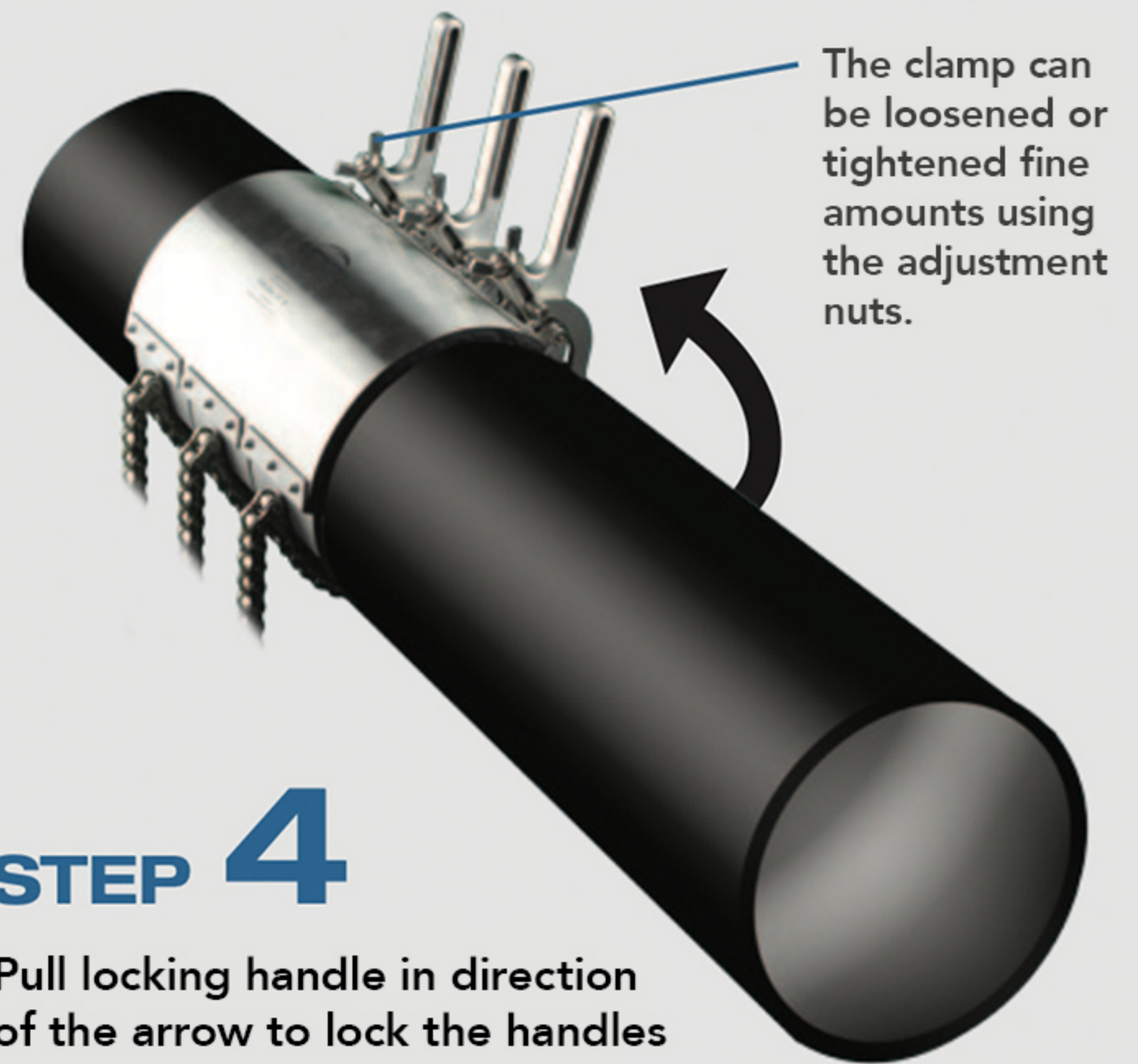

### STEP 4

Pull locking handle in direction  
of the arrow to lock the handles  
in place. Refer to our website  
for a video demonstration.

The clamp can  
be loosened or  
tightened fine  
amounts using  
the adjustment  
nuts.

